

2.180 – H M6      2.183 – H M12  
 2.181 – H M8      2.184 – H M16  
 2.182 – H M10     2.185 – H M20

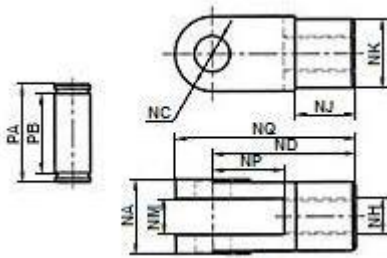

**Horquilla hembra**



Código	Rosca	NA	NC	NH	NK	NM	NP	PA	PB
2.180	M6	12	6	M6	11,5	6	10	17	12
2.181	M8	16	8	M8	14	8	17	19	16
2.182	M10	20	10	M10 x 1,25	18	11	21	25	20
2.183	M12	25,4	12	M12 x 1,25	23	12	24	32,8	26,5
2.184	M16	32	16	M16 x 1,25	30	16	32	39,3	33
2.185	M20	44,4	20	M20 x 1,5	39	20	40	53,3	45

2.190 – M M6      2.193 – M M12  
 2.191 – M M8      2.194 – M M16  
 2.192 – M M10     2.195 – M M20



**Horquilla macho**

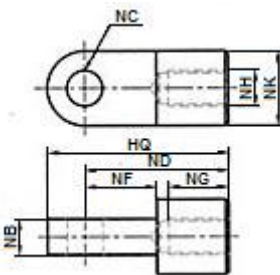

Código	Rosca	NB	NC	ND	NF	NG	NH	NK	HQ
2.190	M6	6	6	24	8,5	10	M6	11,5	30
2.191	M8	8	8	32	11	15	M8	14	40
2.192	M10	10	10	40	15	20	M10 x 1,25	18	51
2.193	M12	12	12	48	24	20	M12 x 1,25	24	67
2.194	M16	16	16	64	32	23	M16 x 1,5	32	89
2.195	M20	20	20	80	40	30	M20 x 1,5	40	112



Darío Martín Carolina SRL

Cnel. Martiniano Chilavert 680  
 (1714) Ituzaingó, Buenos Aires, Argentina

Tel: (011) 4661-1955  
 ventas@dmc-srl.com.ar  
 www.dmc-srl.com.ar